

# For Lease

3017 | 3039 Kilgore Road, Rancho Cordova



## ±1,657 – 24,576 SF Available

As exclusive agents, we are pleased to offer the following space:

- ◆ Office & flex space from ±1,800 - ±25,000 SF
- ◆ Completely updated project
- ◆ Extensive glass & landscaping
- ◆ Suites with immediate occupancy
- ◆ Excellent location with easy access to Highway 50
- ◆ Located in Prospect Park - Sacramento's largest, master-planned office park, housing numerous Fortune 500 companies
- ◆ Extensive nearby amenities including hotels, banking, restaurants and other retail support services
- ◆ Competitive Pricing
- ◆ Site and Floor Plans on Reverse



**Lucas Lugo** Associate Director 916.569.2322 [llugo@newmarkccarey.com](mailto:llugo@newmarkccarey.com) CA RE License #01916673

**Peter Winterling** Senior Managing Director 916.367.6345 [pmw@newmarkccarey.com](mailto:pmw@newmarkccarey.com) CA RE License #00992375

**Todd Eschelman** Senior Managing Director 916.569.2347 [teschelman@newmarkccarey.com](mailto:teschelman@newmarkccarey.com) CA RE License #01916673

**Newmark  
Cornish & Carey**

980 9th Street, Suite 2500, Sacramento, CA 95814

[www.newmarkccarey.com](http://www.newmarkccarey.com)

The information contained herein has been obtained from sources deemed reliable but has not been verified and no guarantee, warranty or representation, either express or implied, is made with respect to such information. Terms of sale or lease and availability are subject to change or withdrawal without notice.

16-0942-07/16



# For Lease

3017 | 3039 Kilgore Road, Rancho Cordova



**Lucas Lugo** Associate Director 916.569.2322 [llugo@newmarkccarey.com](mailto:llugo@newmarkccarey.com) CA RE License #01916673

**Peter Winterling** Senior Managing Director 916.367.6345 [pmw@newmarkccarey.com](mailto:pmw@newmarkccarey.com) CA RE License #00992375

**Todd Eschelman** Senior Managing Director 916.569.2347 [teschelman@newmarkccarey.com](mailto:teschelman@newmarkccarey.com) CA RE License #01916673

**Newmark  
Cornish & Carey**

980 9th Street, Suite 2500, Sacramento, CA 95814

[www.newmarkccarey.com](http://www.newmarkccarey.com)

The information contained herein has been obtained from sources deemed reliable but has not been verified and no guarantee, warranty or representation, either express or implied, is made with respect to such information. Terms of sale or lease and availability are subject to change or withdrawal without notice.

16-0942-07/16

# For Lease

3017 | 3039 Kilgore Road, Rancho Cordova



## 3017 KILGORE - ±23,586 SF

### Availability\*

Suite 1	6,226 SF	Suite 5	1,657 SF
Suite 2	2,539 SF	Suite 6	5,421 SF
Suite 3	2,447 SF	Suite 7	1,985 SF
Suite 4	2,428 SF	Suite 8	1,873 SF

*\*Suites can be combined for larger users*

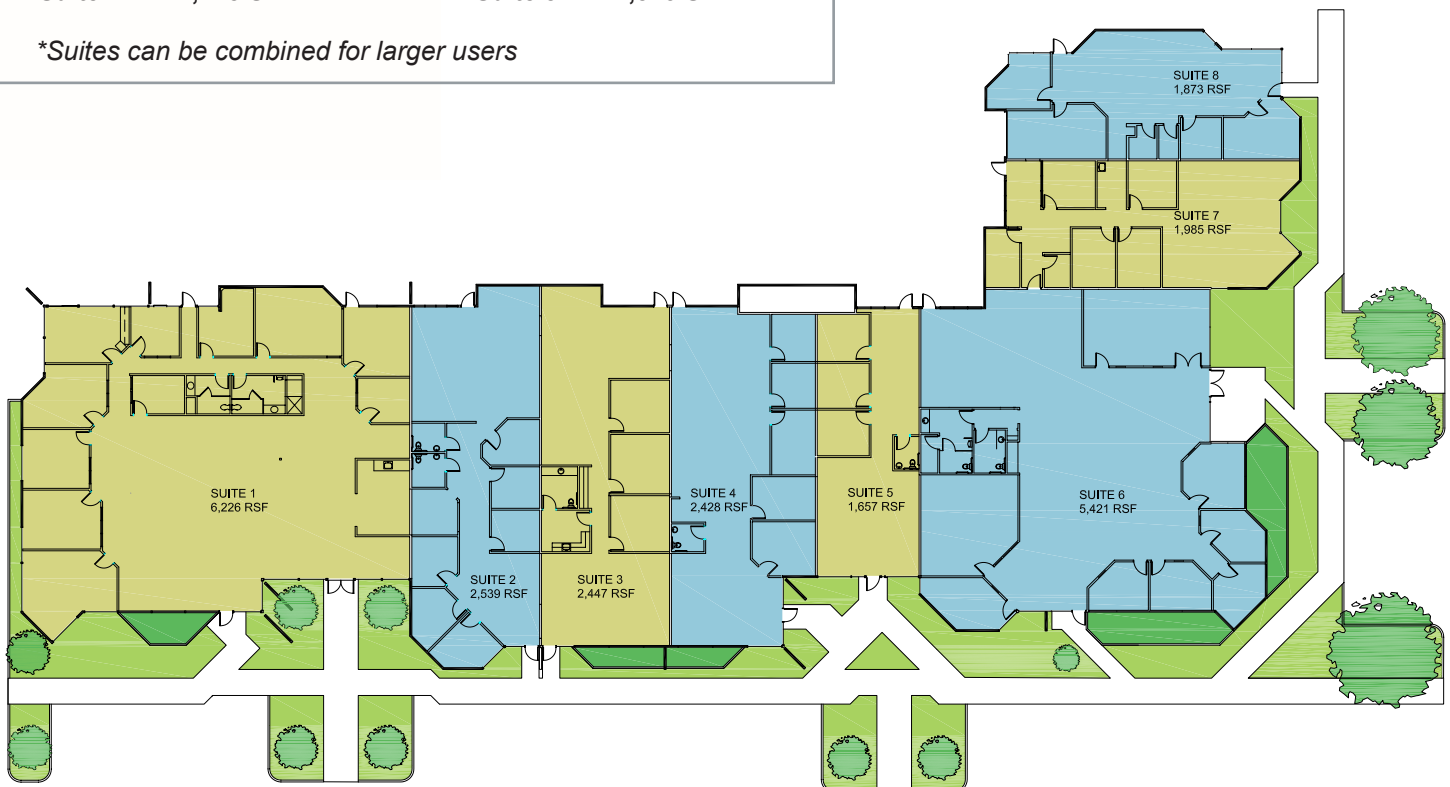

**Lucas Lugo** Associate Director 916.569.2322 [llugo@newmarkccarey.com](mailto:llugo@newmarkccarey.com) CA RE License #01916673

**Peter Winterling** Senior Managing Director 916.367.6345 [pmw@newmarkccarey.com](mailto:pmw@newmarkccarey.com) CA RE License #00992375

**Todd Eschelman** Senior Managing Director 916.569.2347 [teschelman@newmarkccarey.com](mailto:teschelman@newmarkccarey.com) CA RE License #01916673

**Newmark  
Cornish & Carey**

980 9th Street, Suite 2500, Sacramento, CA 95814

[www.newmarkccarey.com](http://www.newmarkccarey.com)

The information contained herein has been obtained from sources deemed reliable but has not been verified and no guarantee, warranty or representation, either express or implied, is made with respect to such information. Terms of sale or lease and availability are subject to change or withdrawal without notice.

16-0942-07/16

# For Lease

3017 | 3039 Kilgore Road, Rancho Cordova



## 3039 KILGORE - ±23,586 SF

### Availability\*

Suite 1	6,226 SF	Suite 5	1,657 SF
Suite 2	2,539 SF	Suite 6	5,421 SF
Suite 3	2,447 SF	Suite 7	1,985 SF
Suite 4	2,428 SF	Suite 8	1,873 SF

*\*Suites can be combined for larger users*

**Lucas Lugo** Associate Director 916.569.2322 [llugo@newmarkccarey.com](mailto:llugo@newmarkccarey.com) CA RE License #01916673

**Peter Winterling** Senior Managing Director 916.367.6345 [pmw@newmarkccarey.com](mailto:pmw@newmarkccarey.com) CA RE License #00992375

**Todd Eschelman** Senior Managing Director 916.569.2347 [teschelman@newmarkccarey.com](mailto:teschelman@newmarkccarey.com) CA RE License #01916673

**Newmark  
Cornish & Carey**

980 9th Street, Suite 2500, Sacramento, CA 95814

[www.newmarkccarey.com](http://www.newmarkccarey.com)

The information contained herein has been obtained from sources deemed reliable but has not been verified and no guarantee, warranty or representation, either express or implied, is made with respect to such information. Terms of sale or lease and availability are subject to change or withdrawal without notice.

16-0942-07/16



# For Lease

3017 | 3039 Kilgore Road, Rancho Cordova



- |                               |                            |
|-------------------------------|----------------------------|
| 1. Bank of America            | 16. Delta Dental           |
| 2. Progressive Insurance      | 17. Dignity Health         |
| 3. MAXIMUS                    | 18. Travelers Insurance    |
| 4. NEC                        | 19. Wells Fargo            |
| 5. BARCO                      | 20. Allstate Insurance     |
| 6. State of CA                | 21. Pearson Schools        |
| 7. Hewlett Packard            | 22. Genworth Financial     |
| 8. GEI                        | 23. eBay                   |
| 9. Wells Fargo Insurance      | 24. Health College         |
| 10. Rancho Cordova City Hall  | 25. Volcano Corporation    |
| 11. Cisco Systems             | 26. Health Net             |
| 12. Residence & Hampton Inn   | 27. Coram Healthcare       |
| 13. Verizon                   | 28. Sprint                 |
| 14. National Career Education | 29. Fairfield Inn & Suites |
| 15. Corelogic                 | 30. Hyatt                  |



**Lucas Lugo** Associate Director 916.569.2322 [llugo@newmarkccarey.com](mailto:llugo@newmarkccarey.com) CA RE License #01916673

**Peter Winterling** Senior Managing Director 916.367.6345 [pmw@newmarkccarey.com](mailto:pmw@newmarkccarey.com) CA RE License #00992375

**Todd Eschelman** Senior Managing Director 916.569.2347 [teschelman@newmarkccarey.com](mailto:teschelman@newmarkccarey.com) CA RE License #01916673

**Newmark  
Cornish & Carey**

980 9th Street, Suite 2500, Sacramento, CA 95814

[www.newmarkccarey.com](http://www.newmarkccarey.com)

The information contained herein has been obtained from sources deemed reliable but has not been verified and no guarantee, warranty or representation, either express or implied, is made with respect to such information. Terms of sale or lease and availability are subject to change or withdrawal without notice.